

DRIVKNUTSDAMASK

Delbar

DRIVKNUTEMANSJETT

Delelig

VETONIVELEN SUOJAKUMI

Jaettavissa

KARDANLEDSMANCHET

Delelig



SE – Enkel montering utan demontering av drivaxel/drivknut, Universalmodel. Innehåll: Delbar gummidamask, fett, 2 rostfria monteringsband, lim och skyddshandskar.

NO – Enkel montering uten demontering av drivaksel/drivknute, Universalmodel. Innhald: delbar gummimansjett, fett, 2 rustfrie monteringsbånd, lim og hansker.

FI – Helppo asentaa tarvitsematta irrottaa vetoakseja tai -niveltä. Yleismalli. Sisältö: jaettava suojakumi, rasvaa, 2 ruostumatonta pantaa, liimaa ja suojakäsineet.

DK – Enkel montering uden afmontering af drivaksel/kardanled, Universalmodel. Indhold: Delbar gummimanchet, fedt, 2 rustfrie monteringsbånd, lim og beskyttelsehandsker.

FAST FIT BOOT

Attention: Maybe the diameter at the small end of the boot is not wide enough. Simply by stretching the boot it can be brought to the required dimension.



1. Content of the boot-kit 72-356.

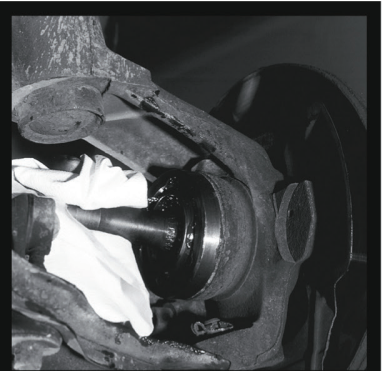

2. Before fitting the boot, remove the old one and thoroughly clean the CV joint and drive-shaft. Everything needs to be free of old-grease and dirt.



4. Start gluing at the small end in areas of 2 cm.

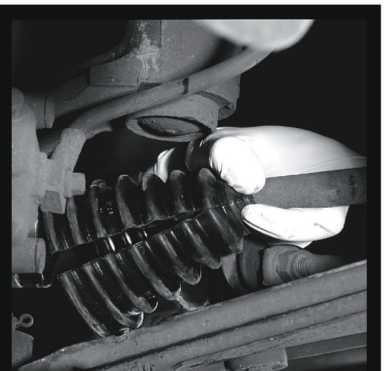

5. This area and all further areas of these 2 cm need to be held tight for 40 sec. each to allow suitable drying time.

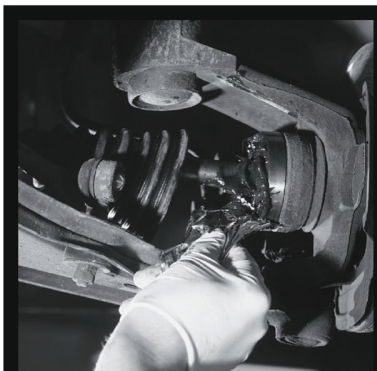

7. Fill up the joint with the included MoS2 special grease. Now fit the boot onto the joint and check the correct hub.

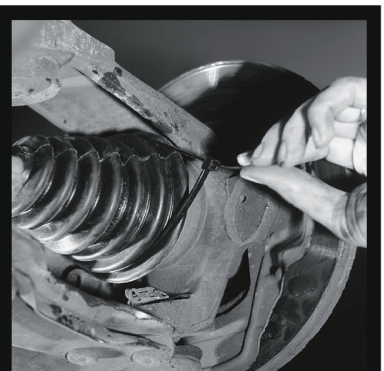

8. Fix the ties and cut off the overlapping tie ends. If needed cut the overlapping boot ends at the drive-shaft and joint too.

**TRILOBE JOINT
COMPATIBLE**



3. Clean hands and use gloves to protect from the glue.



6. After the complete gluing process check the gluing areas and retouch if necessary.

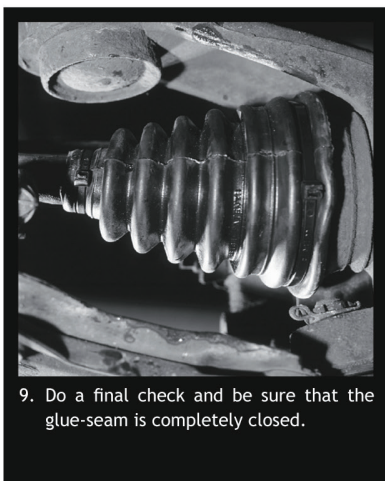

9. Do a final check and be sure that the glue-seam is completely closed.

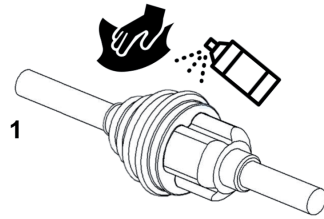

1

Reuse the fist ring of the CV boot

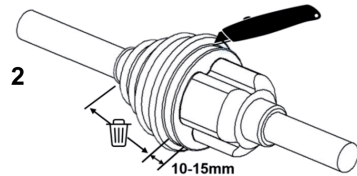

2

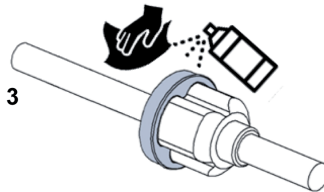

3

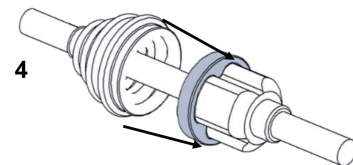

4

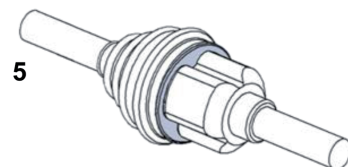

5

MEASUREMENTS FOR FITTING